

**Honeywell's Pneumatic Thermostats
Can Take The Pressure**

Honeywell offers the most accurate, reliable full line of pneumatic thermostats for new construction, modernization or retrofit. They supply proportional control of pneumatic valves and actuators for all of the following applications:



TP970 Series of Pneumatic Thermostats

- Shock-resistant, suspension-mounted thermostats provide dependable performance and responsiveness year in and year out
- Pilot operated models available for high capacity
- Backplate has model air connections – no separate fittings are needed
- Factory calibrated
- Product combinations for a wide number of applications
- 60 years of pneumatic controls history
- Superior quality, performance, and longevity
- A truly open system
- Corrosion resistant materials
- Universal locking cover with various finishes and horizontal, vertical, or blank window options available



TP970 Pneumatic Thermostat

- Two-pipe, single setpoint, pneumatic thermostat
- Direct Acting (DA) and Reverse Acting (RA) models available
 - Typical wide throttling range application
 - Pictured with TRADELINE Thermostat Replacement Kit



TP971 Pneumatic Day/Night Thermostat

- Pneumatic thermostat with night setback and energy savings
- Direct Acting (DA) and Reverse Acting (RA) models available
 - Three-pipe thermostats are available for unit ventilator applications where the outdoor damper must operate when the thermostat is manually set to day operation
 - Pictured with beige Pneumatic Cover Kit

Honeywell Adapter Kits Offer Convenience And Versatility

Honeywell's pneumatic thermostats are available as separate units or for replacement in various kits. These universal kits make replacement and selection easy.

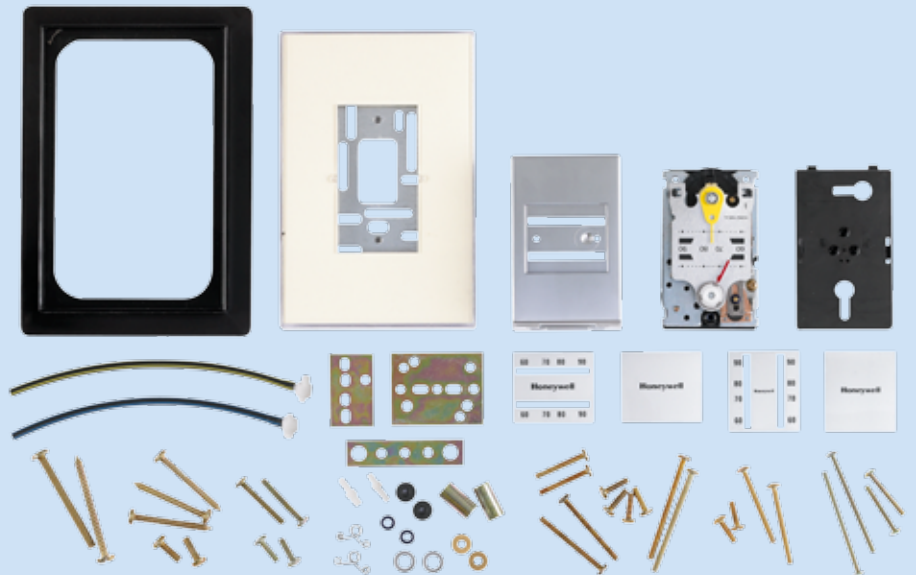

Modernization Kits

- TP970 Series Thermostat, satin chrome cover, universal mounting plate, spacer ring, decorative wall ring, and four cover window inserts plus all necessary hardware for mounting thermostat backplate
- Converts older Honeywell and non-Honeywell one- and two-pipe thermostats to TP970 Series Thermostats

- High or low capacity
- Day/Night control
- Heating/Cooling control
- Single or dual temperature and setpoint
- Horizontal or vertical mounting

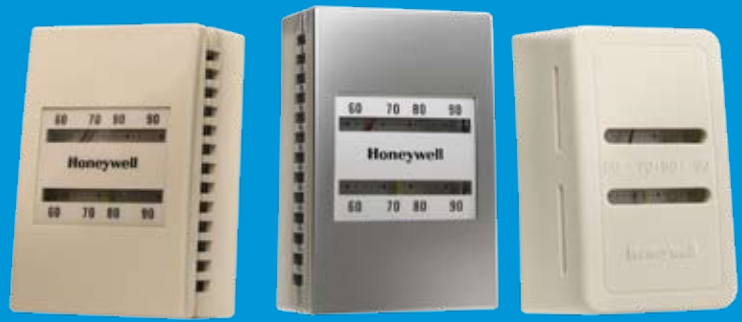

TP972 Pneumatic Heating/Cooling Thermostat

Proportional control of pneumatic valves and dampers with one or two-temperature systems

- Energy conservation model available
- Pictured with Convertastat Kit



TP9600 Pneumatic Thermostat

Proportional control of pneumatic valves and actuators with one- or two-pipe systems

- Unparalleled sensing and control
- Fits your high-volume pneumatic applications
- Cover is mounted and locked into place with concealed setscrews
- Attractive design
- Adapter kits are available to retrofit most pneumatic jobs
- Branchline capacity Low for TP9630 and TP9633
- Branchline capacity High for TP9600, TP9610, TP9603, TP9620



TP973 Pneumatic Low Capacity Thermostat

Proportional control of pneumatic valves and dampers with one or two pipe systems

- Built in restrictor for two-pipe applications
- Pictured with Modernization Kit

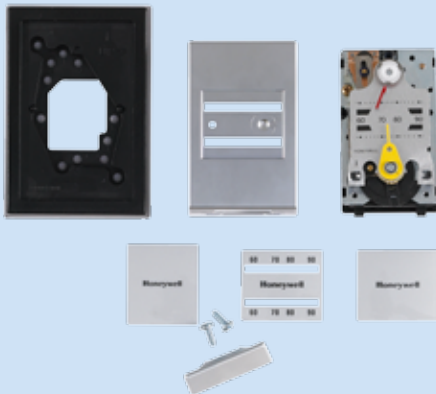

Convertastat Kits

- Includes TP970 Series Thermostat, satin chrome cover, three cover window inserts and universal wall plate adapter
- Converts smaller sized competitive thermostats to the TP970 Series Thermostat
- The dual setpoint and heat/cool thermostat replacement kits allow field adjustment of changeover pressures to match competitors
- Replacement kits are available for Johnson, Powers, Robertshaw, Barber-Colman, and older Honeywell pneumatic thermostats.

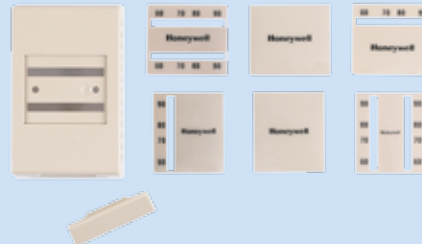

Pneumatic Cover Kits

- Includes cover and cover window inserts
- Available in satin chrome, beige, bright chrome and white for TP970 part numbers and taupe for the TP9600
- Available in Fahrenheit and Celsius formats



TRADELINE Thermostat Replacement Kit

- Includes TP970 Series Thermostat, cover and four cover window inserts
- Vertical or horizontal mounting
- Models for every functional application
- Available in satin chrome

Pneumatic Thermostat Families

| TP9600 Family | | | |
|---|------------------------------|---|---|
| ACTION | TEMP RANGE | PART NUMBER | DESCRIPTION |
| Direct Acting | 60-90 °F | TP9600A1007/U | Thermostat, Visible Setpoint & Temp Cover, 2-pipe, 1 setpoint |
| | | TP9603A1001/U | Thermostat, Concealed Setpoint and Temp Cover, 2 pipe, 1 setpoint |
| | 60-90 °F Day/50-80 °F Night | TP9630A1004/U | Thermostat, Visible Setpoint, Temp cover, 1 or 2 pipe, 1 setpoint, Low capacity |
| Direct Acting- Heating; Reverse Acting- Cooling | 60-90 °F | TP9610A1006/U | Thermostat, Visible setpoint and temp Cover, 2 pipe, 2 setpoint, 13PSI Day/18 PSI Night Control |
| Reverse Acting | | TP9620A1005/U | Thermostat, Visible Setpoint & Temp Cover, DA 18 PSI Heat, RA 13 PSI Cool, |
| | | TP9600B1006/U | Thermostat, Visible Setpoint & Temp Cover, 2 pipe, 1 setpoint |
| | | TP9630B1003/U | Thermostat, Visible Setpoint & Temp Cover, 1 or 2 pipe, 1 setpoint, low capacity |
| TP970 Family - Two-pipe, Single Setpoint | | | |
| ACTION | TEMP RANGE | PART NUMBER | DESCRIPTION |
| Direct Acting | 60-90 °F | TP970A2004/U | Thermostat, Cover Sold Separately |
| | | TP970A2038/U | Thermostat, Universal Modernization kit, Satin Chrome cover |
| | | TP970A2145/U | Thermostat, CONVERT-A-STAT kit, Satin Chrome cover |
| | | TP970A2242/U | Thermostat, CONVERT-A-STAT, Beige cover |
| | | TP970A2259/U | Thermostat, Tradeline kit, Satin Chrome cover |
| Reverse Acting | 15-30 °C | TP970A2020/U | Thermostat, Cover Sold Separately |
| | | TP970A2234/U | Thermostat, CONVERT-A-STAT kit, Satin Chrome Cover |
| | | TP970B2002/U | Thermostat, Cover Sold Separately |
| | 60-90 °F | TP970B2077/U | Thermostat, CONVERT-A-STAT kit, Satin Chrome Cover |
| | | TP970B2166/U | Thermostat, CONVERT-STAT kit, Beige Cover |
| | | TP970B2182/U | Thermostat, Tradeline Kit, Satin Chrome Cover |
| | | TP970B2010/U | Thermostat, Cover Sold Separately |
| 15-30 °C | TP970B2150/U | Thermostat, CONVERT-A-STAT kit, Satin Cover | |
| TP971 Family - Two pipe or Three pipe, Two Setpoint | | | |
| ACTION | TEMP RANGE | PART NUMBER | DESCRIPTION |
| Direct Acting | 60-90 °F Day/50-80 °F Night | TP971A2003/U | Thermostat, 13 PSI Day, 18 PSI Night, Cover Sold Separately |
| | | TP971A2029/U | Thermostat, 16 PSI Day, 21 PSI Night, Cover Sold Separately |
| | | TP971A2086/U | Thermostat, 20 PSI Day, 25 PSI Night, Cover Sold Separately |
| | | TP971A2102/U | Thermostat, CONVERT-A-STAT kit, 13 PSI Day, 18 PSI Night, (Changeover is adjustable to 16/21 psi), Satin Chrome Cover |
| | | TP971C2009/U | Thermostat, 13 PSI Day, 18 PSI Night, Secondary Branchline - 3-pipe, Cover Sold Separately |
| | 15-30 °C Day/10-27 °C Night | TP971C2025/U | Thermostat, 16 PSI Day, 21 PSI Night, Secondary Branchline - 3-pipe, Cover Sold Separately |
| | | TP971A2011/U | Thermostat, 13 PSI Day, 18 PSI Night, Cover Sold Separately |
| | | TP971A2052/U | Thermostat, 16 PSI Day, 21 PSI Night, Cover Sold Separately |
| Reverse Acting | 60-90 °F Day/50-80 °F Night | TP971C2017/U | Thermostat, 13 PSI Day, 18 PSI Night, Secondary Branchline - 3-pipe, Cover Sold Separately |
| | | TP971B2001/U | Thermostat, 13 PSI Day, 18 PSI Night, Cover Sold Separately |
| | | TP971B2019/U | Thermostat, 16 PSI Day, 21 PSI Night, Cover Sold Separately |
| | | TP971B2043/U | Thermostat, 20 PSI Day, 25 PSI Night, Cover Sold Separately |
| TP972 Family - Two pipe, Single and Dual setpoint | | | |
| ACTION | TEMP RANGE | PART NUMBER | DESCRIPTION |
| Direct Acting- Heating Reverse Acting- Cooling | 60-90 °F | TP972A2002/U | Thermostat, 18 PSI Heat, 13 PSI Cool, Cover Sold Separately |
| | | TP972A2143/U | Thermostat, 14 PSI Heat, 19 PSI Cool, Cover Sold Separately |
| | | TP972A2192/U | Thermostat, CONVERT-A-STAT kit, 18 PSI Heat, 13 PSI Cool, 2 pipe, Single Set point, Satin Chrome Cover |
| | 50-75 °F Heat/ 60-90 °F Cool | TP972A2036/U | Thermostat, Energy Conservation Model, 18 PSI Heat, 13 PSI Cool, 2 concealed Set Points, Cover Sold Separately |
| 15-30 °C | TP972A2010/U | Thermostat, 18 PSI Heat, 13 PSI Cool, Cover Sold Separately | |
| TP973 Family - One or Two pipe, Single setpoint, Low capacity | | | |
| ACTION | TEMP RANGE | PART NUMBER | DESCRIPTION |
| Direct Acting | 60-90 °F | TP973A2076/U | Thermostat, Cover Sold Separately |
| | | TP973A2209/U | Thermostat, Tradeline kit, Satin Chrome Cover |
| | 15-30 °C | TP973A2084/U | Thermostat, Cover Sold Separately |
| Reverse Acting | 60-90 °F | TP973B2066/U | Thermostat, Cover Sold Separately |
| | | TP973B2171/U | Thermostat, Tradeline kit, Satin Chrome Cover |
| | 15-30 °C | TP973B2074/U | Thermostat, Cover Sold Separately |

| Pneumatic Cover Kits | | |
|----------------------|--------------------------------|-----------------------------------|
| PART NUMBER | DESCRIPTION | WORKS WITH: |
| 14004406-910 | Satin Chrome Kit - Fahrenheit | TP970, TP971, TP972, TP973, TP974 |
| 14004406-910C | Satin Chrome Kit - Celsius | TP970, TP971, TP972, TP973, TP974 |
| 14004406-910H | Satin Chrome Kit - Humidistat | HP970, HP971, HP972 |
| 14004407-910 | Beige Kit - Fahrenheit | TP970, TP971, TP972, TP973, TP974 |
| 14004407-910C | Beige Kit - Celsius | TP970, TP971, TP972, TP973, TP974 |
| 14004787-910 | Bright Chrome Kit - Fahrenheit | TP970, TP971, TP972, TP973, TP974 |
| 14004878-910 | White Kit - Fahrenheit | TP970, TP971, TP972, TP973, TP974 |
| 14004910-001 | Taupe Visible Fahrenheit Scale | TP9600 |
| 14004910-004 | Taupe Blank Cover | TP9600 |

Learn More

Visit customer.honeywell.com

Automation and Control Solutions

In the U.S.:

Honeywell

1985 Douglas Drive North

Golden Valley, MN 55422-3992

In Canada:

Honeywell Limited

35 Dynamic Drive

Toronto, Ontario M1V 4Z9

67-7383 PR

March 2010

© 2010 Honeywell International Inc.



Honeywell